

NEW NEW

EYE★POD™

MAJOR ADVANCE TAKES THE WORRY OUT OF CONTACT LENSES & EYE DROPS



#1 **Best Way** to put CONTACT LENSES IN & OUT IN 1 Second! FINGER-FREE on EXACT Center of eyes - EYE-DROPS TOO! Never need to bend over Backwards!

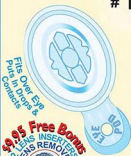

ALL NEW Triple Action

Doctor Recommended



REJUVENATE & PLEASURE

Your Eyes CAN Save 60%+ FOREVER on EYE DROPS!

©2009 Hot Ideas World Inc. W.W. Patents Pending USA Designed

Precisely Place Eye-Drops without needing to bend over backwards! Inserts/REMOVES Lens Finger-Free! Quick Relief of Dry eyes, Blood Shot Eyes, Irritated Computer Tired-eyes. Saves money Every time you put in Eye-Drops for Cataracts, Glaucoma, Allergies, Diabetes, Lasiks. It's Easier, Quicker & Safer. Purse & Pocket PORTABLE. It Quickly pays for itself!

Ver Las Instrucciones

BIG NEWS!

See Instructions on Back

EYE★POD

★NEW★

CONTACT LENS Finger-Free EZ Inserter & Remover +

Eye DROPS: \$\$\$ Saving Precision 1 Single-Drop Delivery!

No more bending head back or mirrors needed!

Scientific Invention Makes Contacts & Eye Drops Easier, Safer, & Quick

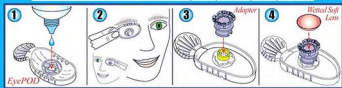

- 1 Squeeze 1 or 2 drops in center Round chamber. Drops/Lens won't fall out even if upside down.
- 2 Put Eye*Pod gently over your eye, resting on the Eye Lids, press lightly and the Drop will jump onto the eye & wet it. Save 60% ± on Eye Drops. Always use clean hands.
- 3 Put rubber ADAPTER on Tube with Big End Up.
- 4 Put Soft lens on center of dry or wet Adapter.

Contact Lens EZ Insertion & Removal - Finger-FREE! - Fast & Hygienic!

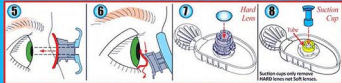

- 5 Raise Soft lens to eye. Hold eyelids Wide open. Look into Tunnel-of-Light™. Bring lens very close to eye and Gently place Lens on eye. It goes on the Exact center of eye. Easy!
- 6 Look into Tunnel-of-Light™ to align Adapter to Lens on your eye. Press Adapter on Lens and slide lens down & rotate out of eye onto cheek. Use Adapter to pick lens off cheek and put it in lens case. A little practice and it becomes Very Easy.
- 7 Put WET HARD lens on Small End of Adapter. Raise to eye. Hold eyelids Wide open. Look into Tunnel-of-Light. Bring lens very close to eye. Lens will jump on Exact center of your eye. Easy!
- 8 The Best way to remove HARD Contact lenses is with the Eye-POD's 1-&-Only Triple SAFE SUCTION CUP. Wet the Tube 1st. Press the Suction Cup fully into the Tube and onto the Post. Then Wet the Suction Cup also with water or lens liquid. Hold Eye Lids Wide open. Raise to eye. Look into Tunnel-of-Light to center Suction Cup on the Hard Lens. Gently press Suction Cup on Lens. Remove lens from eye and deposit it in lens case - Fast & Easy! All Finger-FREE. With a little practice, it takes less than a second. It stops stretching the skin at edges of your eyes that creates aged looking 'crows feet' over time. Also saves you losing costly Lenses. The Eye-POD Does it ALL! Enjoy! Always have spares tell a Friend!

EyePODMagic® See 'How To' Video on Web Site

